

# SPROUT DISASSEMBLY INSTRUCTIONS

## NOTES

All materials removed and disassembled shall be sorted and segregated with like materials and disposed of or recycled according to recycling availability or waste acceptance.

This product is recyclable in all communities with large item recycling programs.

1

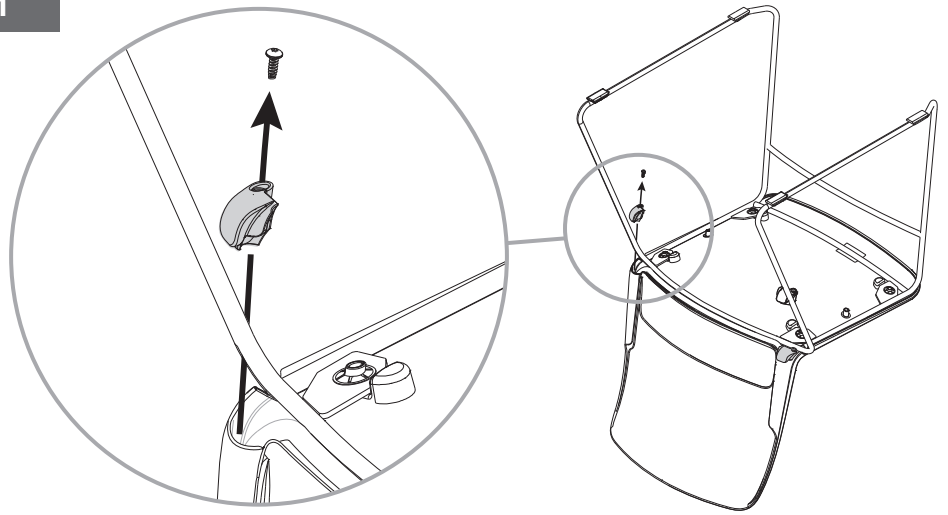

## REQUIRED TOOLS

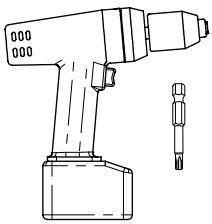

Cordless Drill/Driver and T20 Torx Bit

OR



T20 Torx Screwdriver



Non-Marring Mallet/Hammer

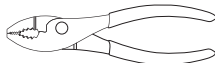

Channel Lock Pliers

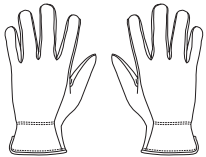

Safety Gloves



Safety Glasses

2

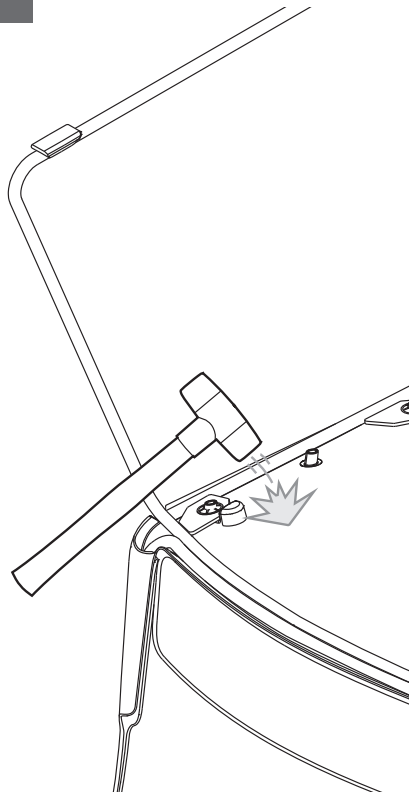

3

## METAL



Screws



Push Nuts

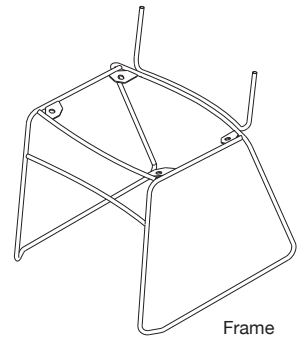

Frame

## PLASTIC



Back Bumpers



Glides



Seat Bumpers

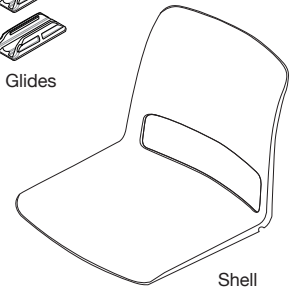

Shell

## INSTRUCTIONS

1. Using a T20 Torx screwdriver, remove the half inch screws that attach the bumpers to the frame.
2. Remove the shell from the frame by striking the four corners, near the push nuts. Then, pull the seat and frame apart and, if applicable, remove the glides attached to the frame with channel lock pliers. The bumpers will fall off when the shell and frame are separated.
3. Separate materials for recycling.