

# Dual Torsion Heavy Duty (DT)

SitOnIt • Seating®

## CHAIR ADJUSTMENT INFORMATION (AVAILABLE ON NON-STOP ONLY)

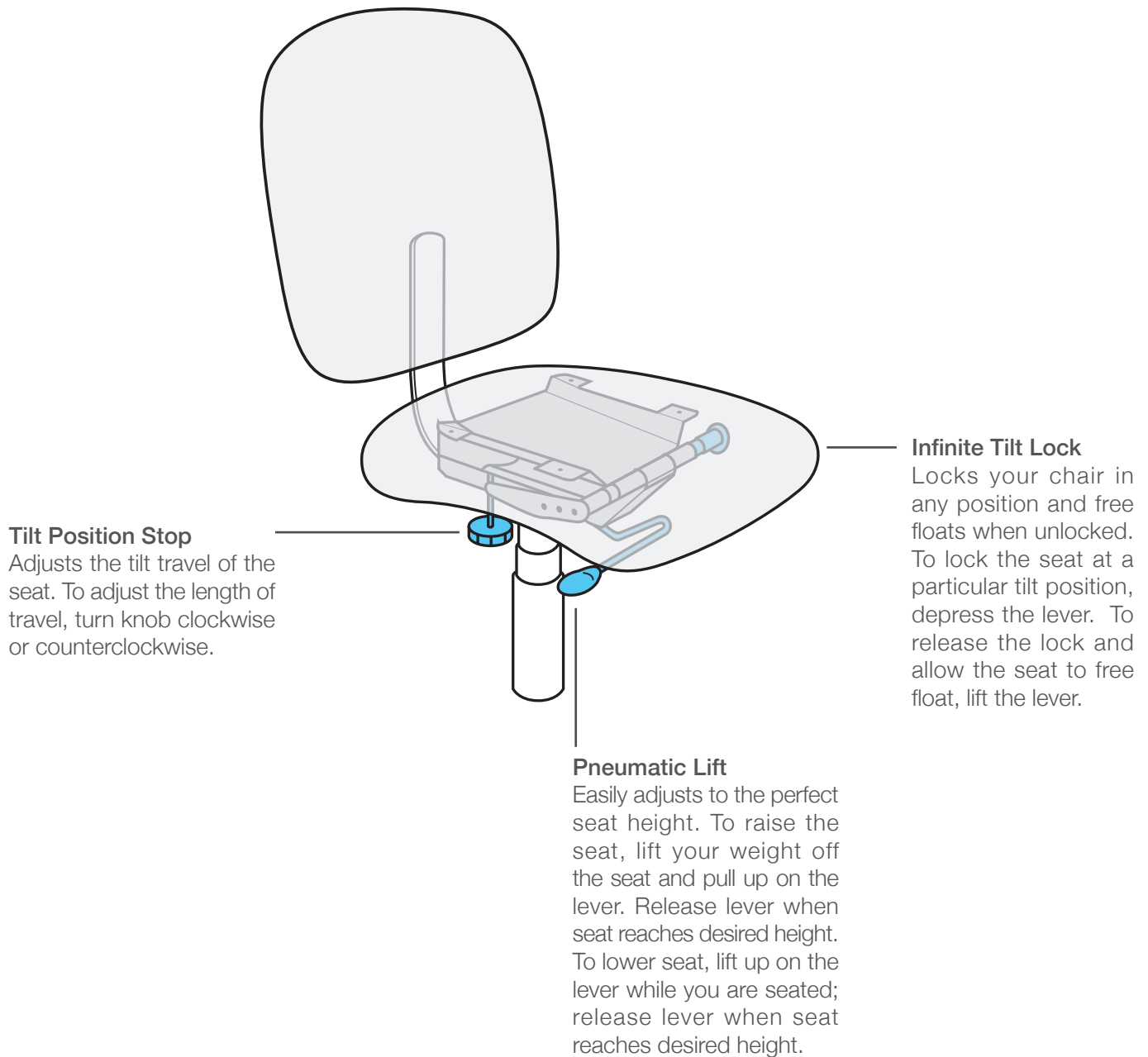

**Tilt Position Stop**  
Adjusts the tilt travel of the seat. To adjust the length of travel, turn knob clockwise or counterclockwise.

**Infinite Tilt Lock**  
Locks your chair in any position and free floats when unlocked. To lock the seat at a particular tilt position, depress the lever. To release the lock and allow the seat to free float, lift the lever.

**Pneumatic Lift**  
Easily adjusts to the perfect seat height. To raise the seat, lift your weight off the seat and pull up on the lever. Release lever when seat reaches desired height. To lower seat, lift up on the lever while you are seated; release lever when seat reaches desired height.

SitOnIt • Seating®