

# Mobio

## POWER BLOCK ASSEMBLY INSTRUCTIONS

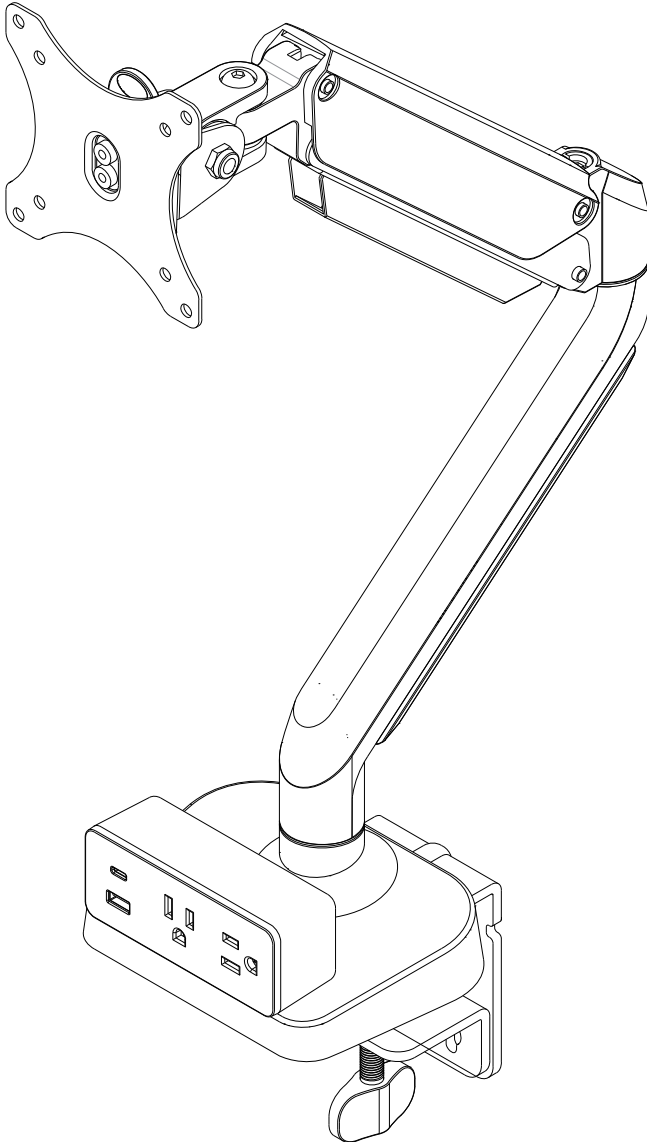

Read the entire instruction manual before you start installation and assembly. If you have any questions regarding any of the instructions or warnings, please contact your local distributor for assistance.

To report any issues with this product, contact our customer experience team at: (888) 274-8664 or [sitonit@exemplis.com](mailto:sitonit@exemplis.com).



## **DANGER**

### **RISK OF FIRE AND SHOCK**

Never overload electrical circuits.

Do not touch the power source with wet hands.

Keep all components clean and dry.

Do not use the power block if there are any signs of damage to the electrical cord.

### Recommended Tools

---

- 4 mm Hex Key

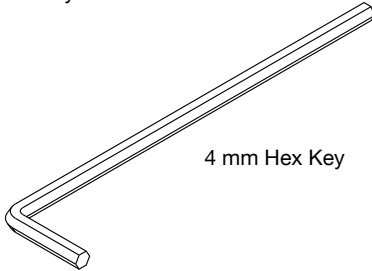

### Parts: Bolt-through/grommet style installation

---

- Power Block (1)
- M5 x 8 mm Screw (2)

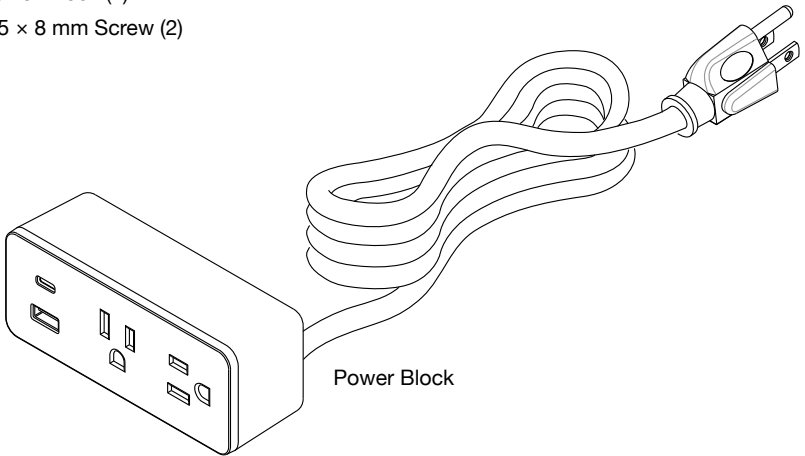

### HARDWARE

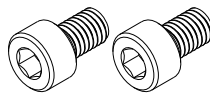

M5 x 8 mm Screws

**Step 1:** Push up on the lower bracket to detach it from the top bracket.

---

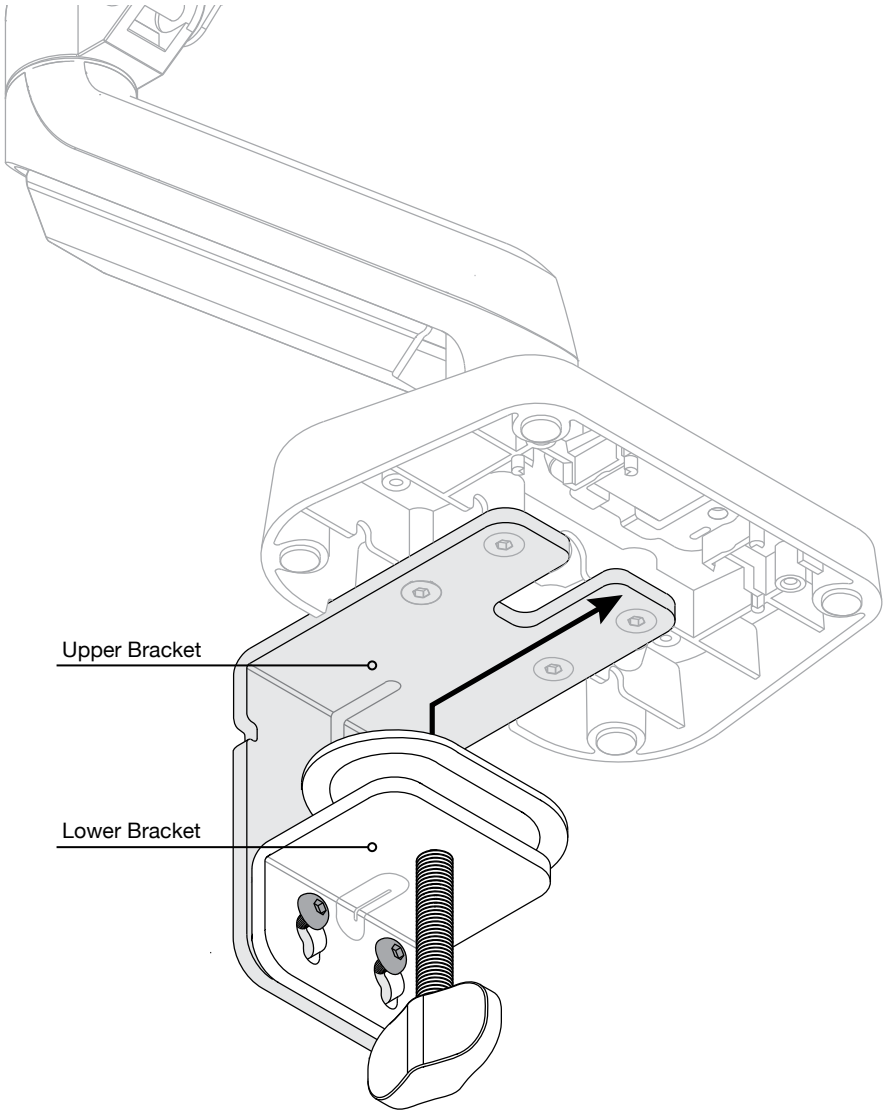

**Step 2:** Uninstall the upper bracket by removing the screws.

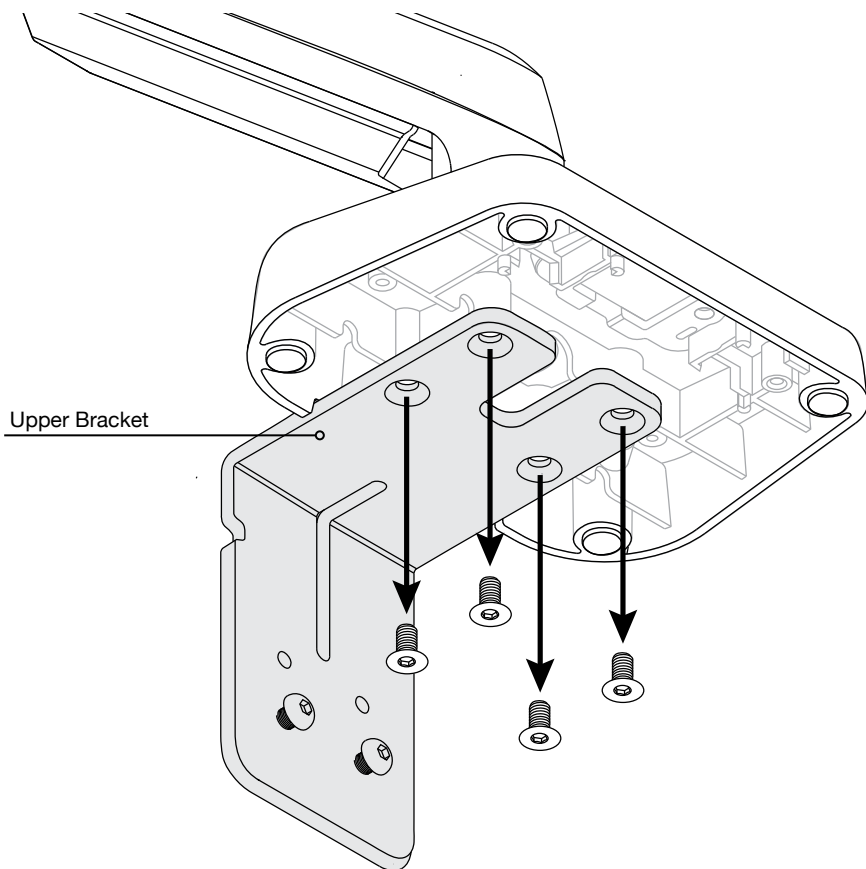

**TOOLS**



4 mm Hex Key

**Step 3:** Pop off the power block cover by pushing on its underside.

---

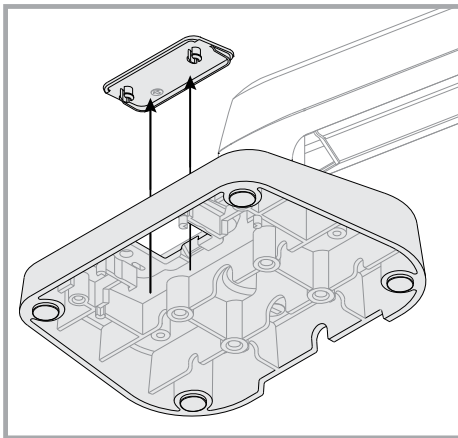
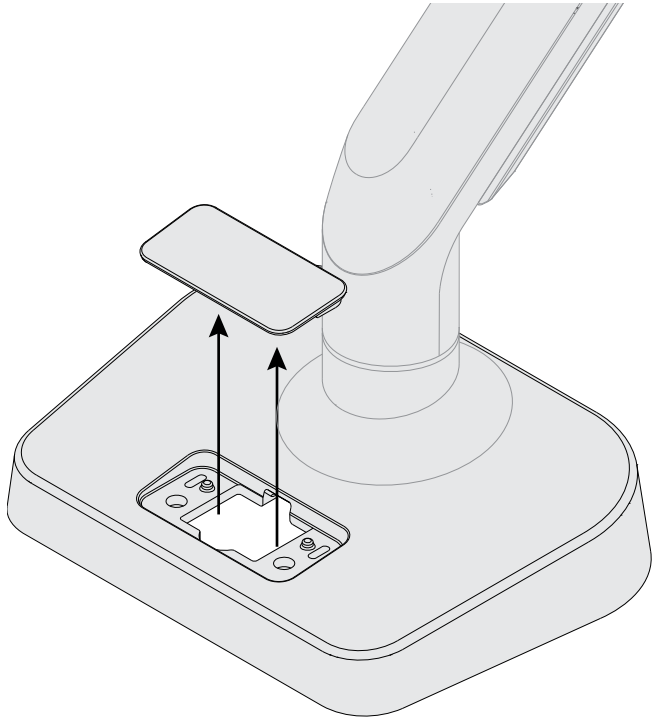

**Press up from the underside.**

**Step 4:** Route the power cord through the opening.

---

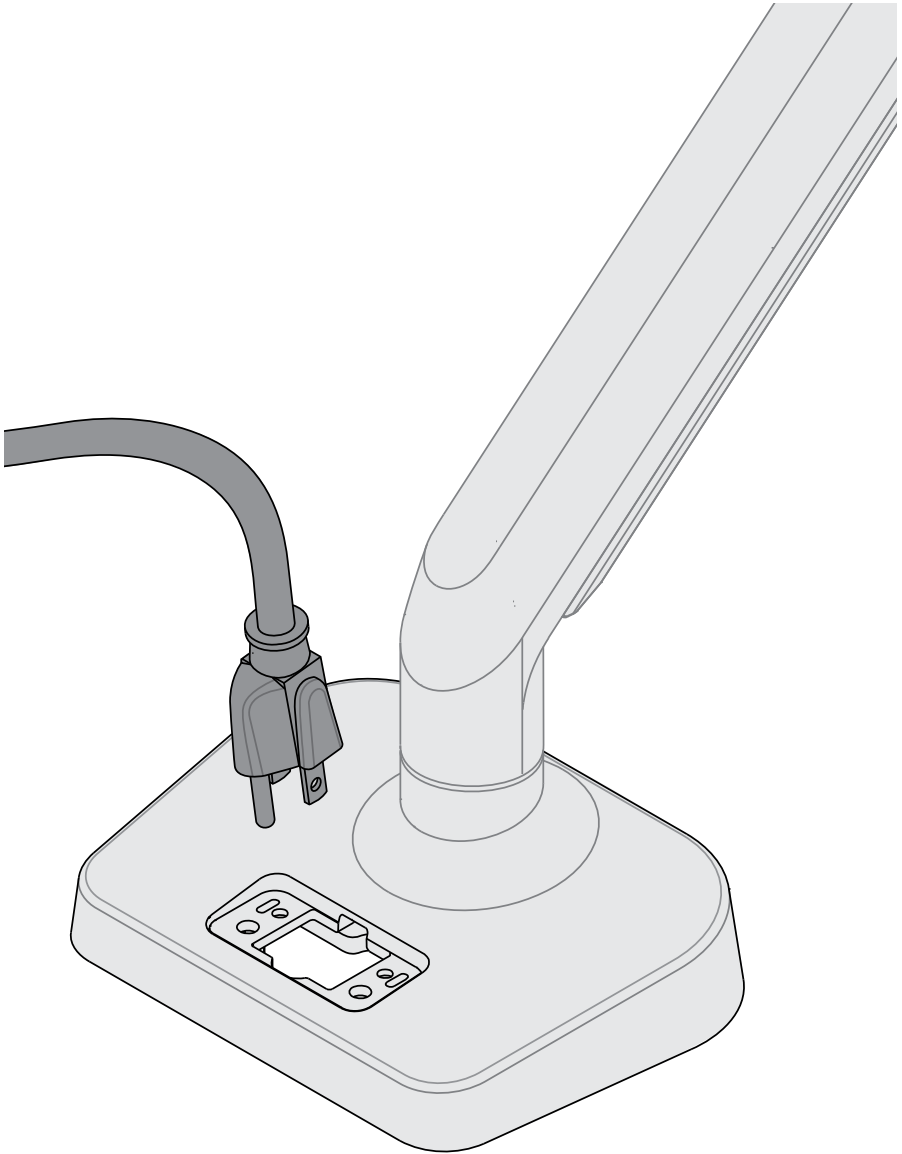

**Step 5:** Snap the power block into the monitor arm base.

---

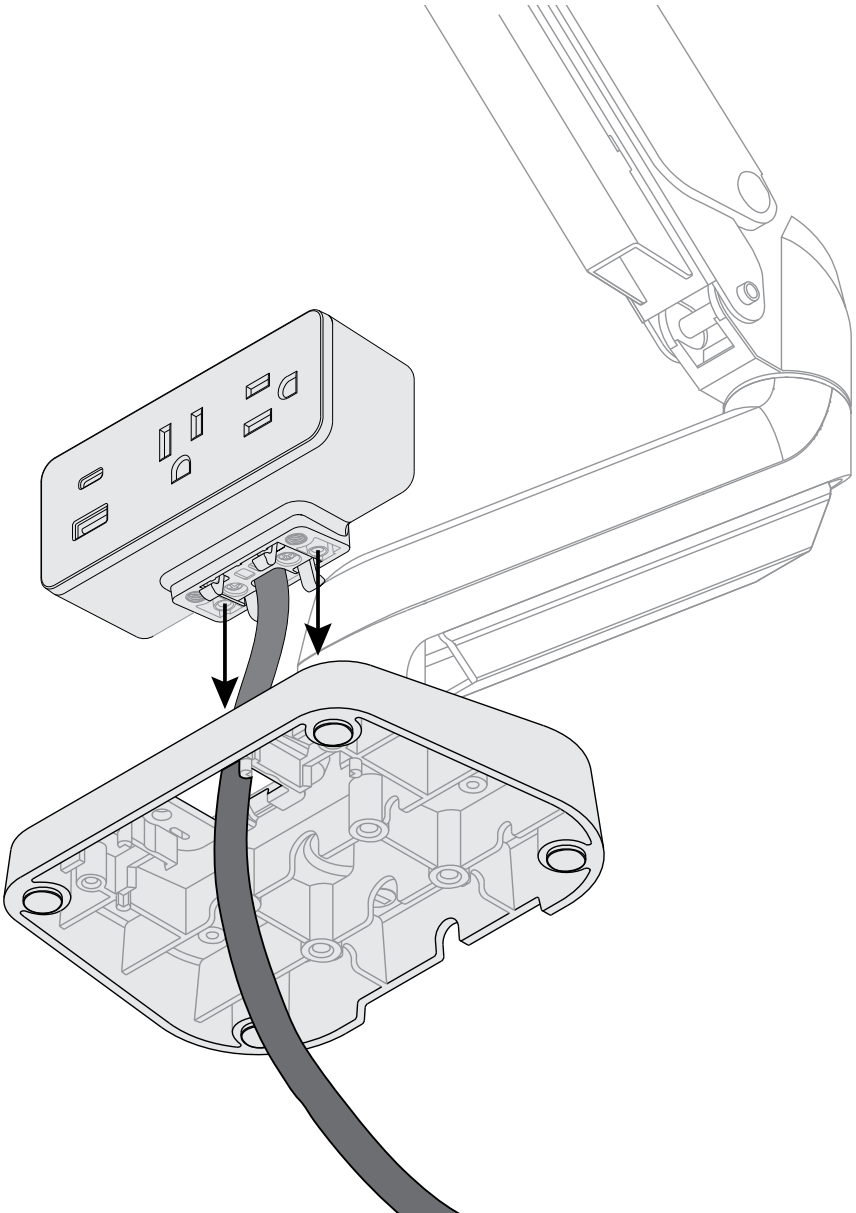



**Step 6:** Fasten the power block in place.

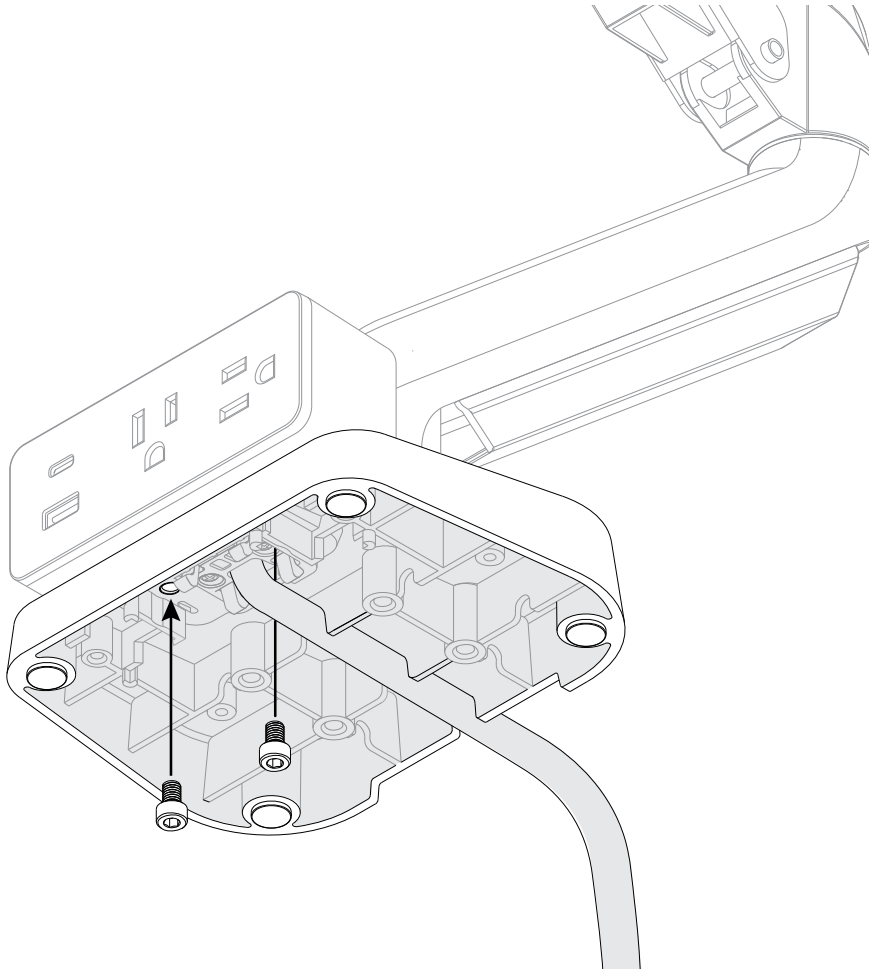

**1:1 HARDWARE**

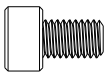

M5 x 8 mm

**TOOLS**



4 mm Hex Key

**Step 7:** Reinstall the upper bracket with the screws removed in step 2.

For information on the bolt-through/grommet mount installation, see the Mobio Monitor Arm Assembly Instructions" work for you?

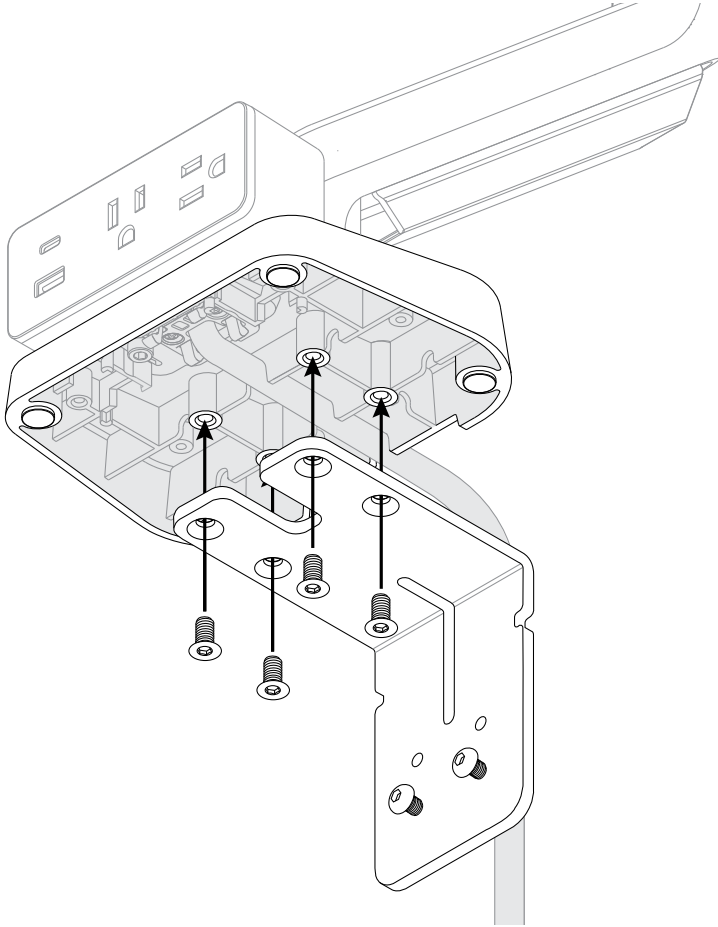

1:1 HARDWARE

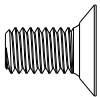

M6 x 12mm

TOOLS



4 mm Hex Key

**Step 8:** Reattach the lower bracket.

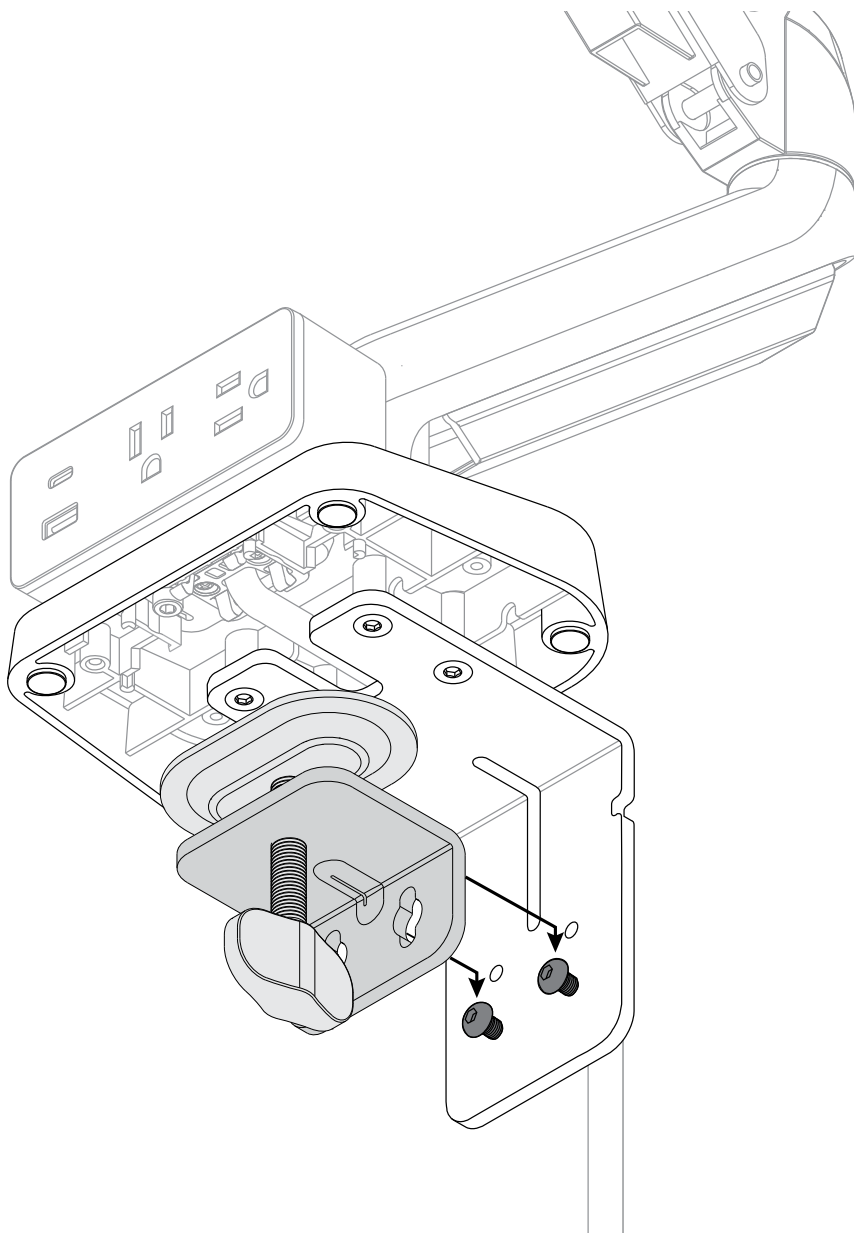

## Specifications

### Power Input

Input Connection Type	NEMA 5–15P
Power Cord	8 ft, SJT 14AWG × 3C

### Power Output

Output Connection Type	NEMA 5–15R
Number of Outlets	2

### Electrical Rating

Voltage Compatibility	125 VAC
Ampere Compatibility	15A
Frequency Compatibility	50/60 Hz
Watts	1875 W

### USB Charging

USB A+C Charging Ports	20W (Max)
Type C Only	5V/3A, 5V/3A, 9V/2A, 12V/1.66A
Type A Only	5V/3A
Type A+C Used at the Same Time	5V/3A

### Physical

Dimensions	114 mm (L) × 40 mm (D) × 54 mm (H)
Material	Polycarbonate

### Certifications

UL 962A 5th Edition (Furniture Power Distribution Units)